

## Description

This kit includes parts and hardware for replacing the shock frame panel on the iNjX.

Tools Required	Qty.
2.5 mm Hex Driver	1
T15 Torx Driver	1
T20 Torx Driver	1
T25 Torx Driver	1

Parts Supplied	Qty.
Shock Frame Panel	1
M5 Screw	2
T20 Sheet Metal Screw	12
T25 Pan Head Cap Screw	2
T15 Flat Head Screw	2
Rubber Bumper	2
Loctite® Threadlocker (Blue 242)	1

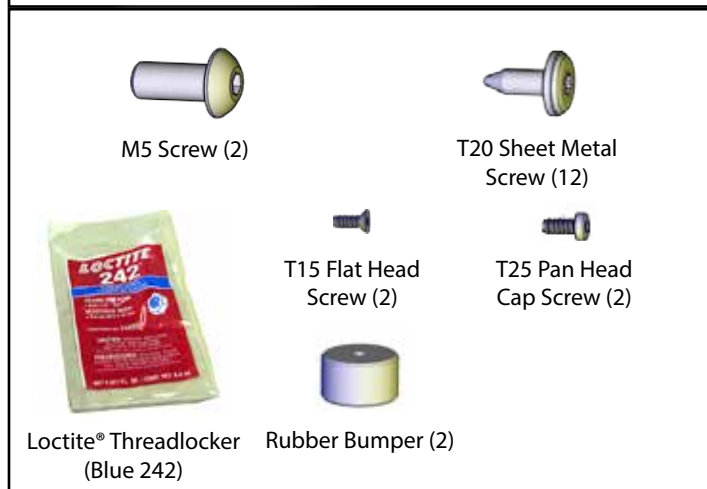
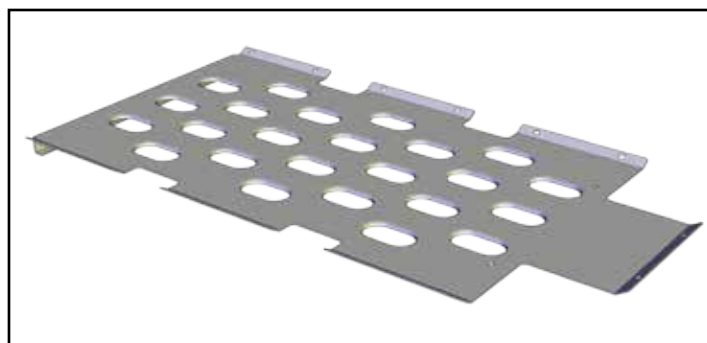

**⚠ WARNING**

**Improper installation and use of the kit can cause injury. Install and use the kit only as described in this manual.**

**Improper parts and service can cause injury. Use only Ferno parts and Ferno-approved service on the product.**

**Modifying the kit can cause injury and damage. Use the kit only as designed by Ferno.**

## Before You Begin

1. Before beginning any service or repairs, turn the iNjX power OFF and disconnect the battery cable from the battery.
2. Place the iNjX on a suitable work surface and engage the wheel locks.

**NOTICE**

Do not reuse nuts, bolts, roll pins, or fasteners. Always use new fasteners when making repairs.

Always clean and prime screw threads before applying Loctite® threadlocker.

Allow the Loctite® threadlocker to dry for a minimum of one hour before using the cot. Full cure time is eight hours.

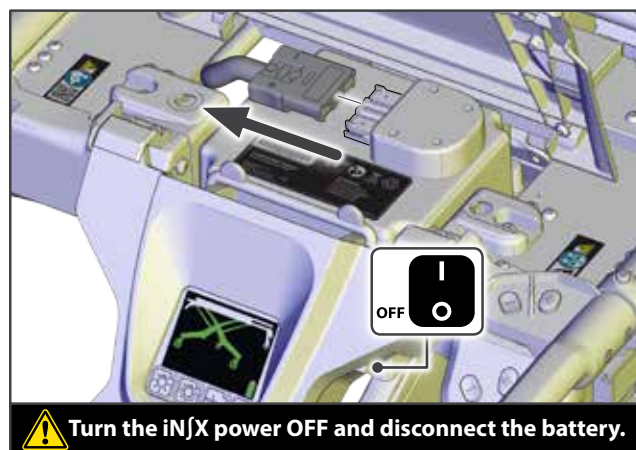

## Removing the Shock Frame Panel

1. Remove the locking mattress pad from the patient surface.
2. Use the 2.5 mm hex driver to remove the M5 screws from the two corners of the shock frame panel at the hinge (Figure 1).
3. Use the T20 Torx driver to remove the 12 sheet metal screws from the shock frame panel. Discard the screws.
4. Note the orientation of the manual release mount plug and which oval hole it belongs in. Use the T15 Torx driver to remove the two screws from the manual release mount plug. Note the location and orientation of the plug. Set the manual release and mount plug aside. Discard the screws.

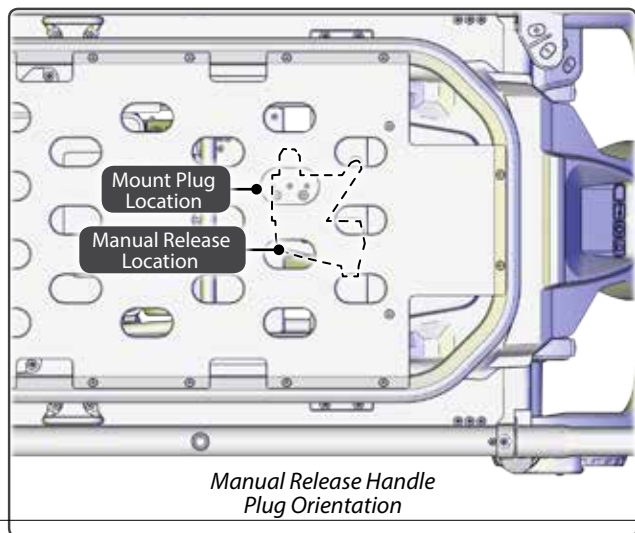

## Installing the Shock Frame Panel

1. Use the T25 Torx driver and two T25 pan head cap screws to attach the rubber bumpers to the shock frame panel. Do not use Loctite.
2. Place the shock frame panel between the frame rails. Align the screw holes in the tabs to the screw holes in the frame.
3. Clean the threads of the M5 screws, plus the receiving threads in the shock frame with acetone or an appropriate Loctite cleaner/primer (not supplied). Allow the threads to dry completely.
4. Apply 1 drop of threadlocker to the threads of each screw. Install the screws immediately. Wipe off any excess threadlocker.
5. Use the 2.5 mm hex driver and two M5 screws to attach two shock frame panel corners to the hinges (Figure 1).
6. Use the T20 Torx driver and twelve T20 sheet metal screws to attach the shock frame panel side tabs to the shock frame.
7. Raise the shock frame to the upright position.
8. Note the orientation of the plug and handle as shown in Figure 1 inset. Use the T15 Torx driver and two T15 flat head screws to attach the manual release plug. Insert the screws through the manual release plug and into the receiving holes in the manual release. Tighten all screws.
9. Reinstall the mattress pad.

### NOTICE

The M5 screws must be put in the proper location to attach the shock frame panel to the hinge.

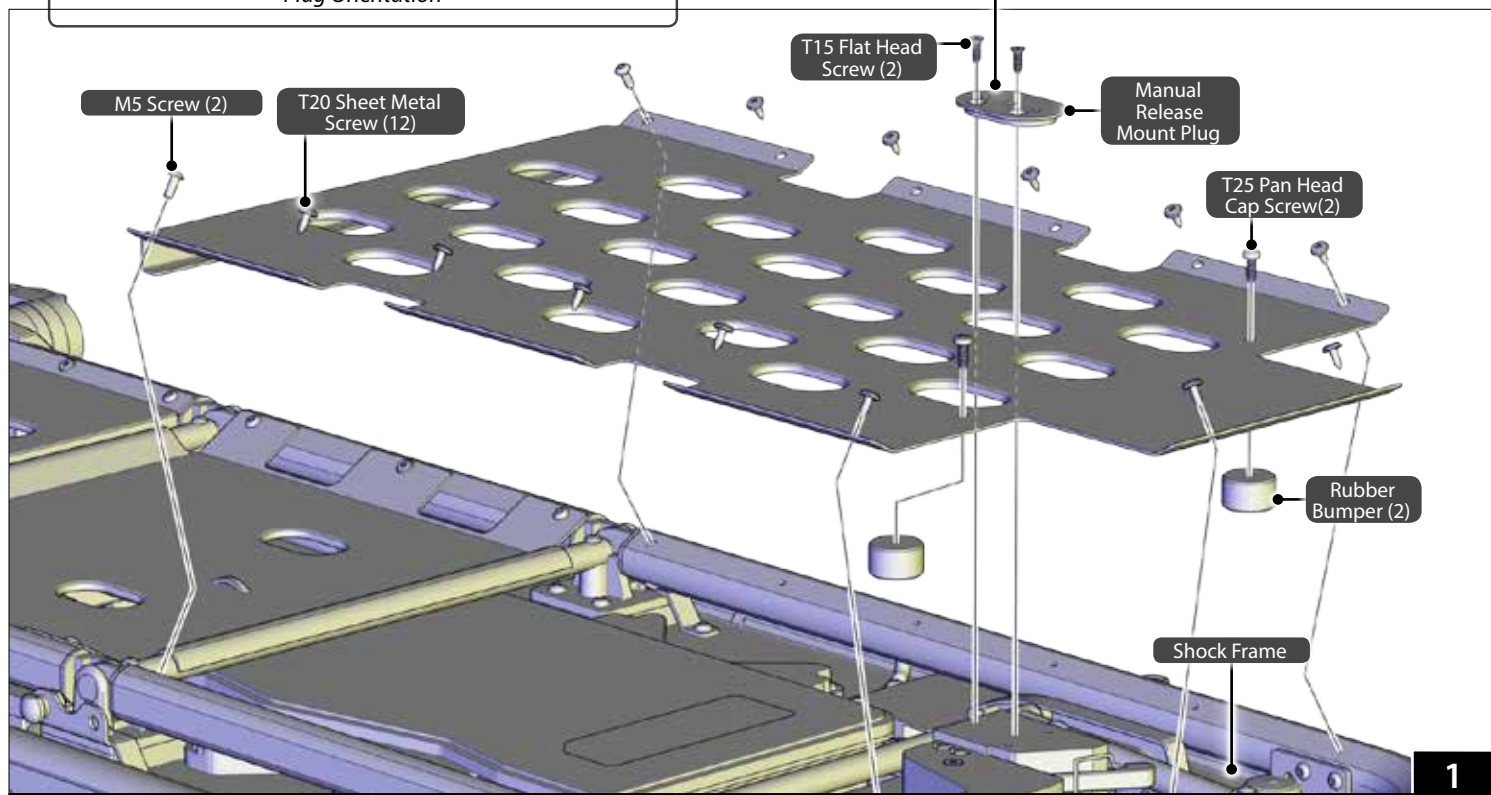

## Repairs or Parts

EMSAR® is the only organization authorized by Ferno to manage, service, and repair Ferno products.



Telephone (Toll-free)	1.800.73.EMSAR
Telephone (Worldwide)	1.937.383.1052
Fax (Worldwide)	1.937.383.1051
Internet	www.EMSAR.com

## Ferno Customer Relations

For ordering assistance or general information:

### CANADA AND THE U.S.A.

Telephone (Toll-free)	1.877.733.0911
Telephone	1.937.382.1451
Fax (Toll-free)	1.888.388.1349
Fax	1.937.382.1191
Internet	www.ferno.com

### ALL OTHER LOCATIONS

For assistance or information, please contact your Ferno distributor. If you do not have a Ferno distributor, please contact Ferno Customer Relations:

Ferno-Washington, Inc., 70 Weil Way  
Wilmington, Ohio 45177-9371, U.S.A.

Telephone	+1.937.382.1451
Fax	+1.937.382.6569
Internet	www.ferno.com

## Limited Warranty Statement

The products sold by Ferno are covered by a limited warranty, which is printed on all Ferno invoices. The complete terms and conditions of the limited warranty, and the limitations of liability and disclaimers, are also available upon request by calling Ferno at 1.800.733.3766 or 1.937.382.1451.



Ferno-Washington, Inc.  
70 Weil Way  
Wilmington, Ohio 45177-9371 U.S.A.  
1.937.382.1451



Ferno (UK) Limited  
Stubs Beck Lane, Cleckheaton  
West Yorkshire BD19 4TZ, United Kingdom  
44 (0) 1274 851999